

F.R. unit B7019 Series

Air filter/regulator integrated.

- Port size: Rc1/8, Rc1/4

JIS symbol



Specifications

1 MPa = 10 bar

Item	B7019-1C/2C	
Max. working pressure	MPa	1.0 (≈150 psi, 10 bar)
Proof pressure	MPa	1.5 (≈220 psi, 15 bar)
Ambient / fluid temperatures	°C	5 (41°F) to 65 (149°F)
Filtration rating	μm	5
Set pressure	MPa	0.04 (≈5.8 psi) to 0.83 (≈120 psi)
Pressure relief		With relief mechanism
Port size	Rc	1/8 / 1/4
Weight	kg	0.4
Bowl guard		Made to order

*1: When a piston drain (D) is used, min. working pressure is 0.1 MPa.
Do not use this device on equipment that experiences impacts.

Flow characteristics

- B7019-1/2C Rc1/8 / 1/4

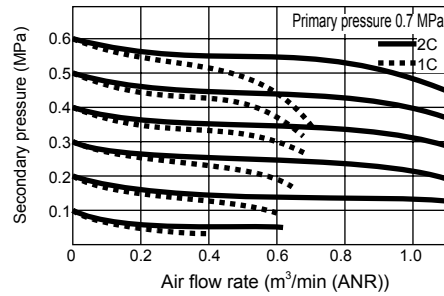

Pressure characteristics

- B7019

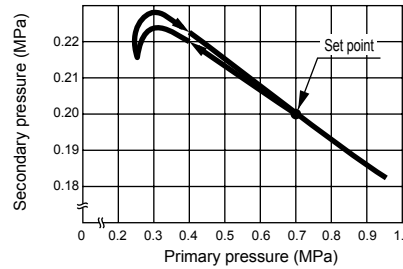

How to order

B7019 - **2C** - **DZNGB**

A Port size
*1

B Option

[Example of model No.]

B7019-2C-DZNGB

Model: F.R unit miniature

A Port size: Rc 1/4

B Option: Piston drain, nylon bowl, non-relief, pressure gauge included, bracket included

⚠ Precautions for model No. selection

- *1 : If port size NPT thread is required, do not indicate nominal size C.
(Example) B7019-1: If a pressure gauge is selected, the NPT thread pressure gauge is enclosed.
- *2 : Two or more codes can be selected per "Regulator" and "Included product".
- *3 : When selecting the bowl material "M" and the enclosed product "G", specify "M-G".
- *4 : If the pressure gauge is "L" for low-pressure, G49D-6-P04 is enclosed.
Refer to related products (page 363) for pressure gauge specifications.
- *5 : Pressure gauge for "LG" is 0 to 0.4 MPa.
- *6 : Refer to page 413 for the included "B" bracket.

Code	Description	
A Port size		
1C	Rc1/8	
2C	Rc1/4	
B Option		
Drain discharge	Blank	Tire valve
	D	Piston drain
Bowl material	Blank	Polycarbonate bowl
	Z	Nylon bowl
	M	Metal bowl
	Q	Polycarbonate bowl with bowl guard
Element	Blank	5 μm
	Blank	Standard
Regulator	N	Non-relief
	L	For low pressure (0.02 to 0.34 MPa)
Included product	Blank	Not included
	G	Pressure gauge (G49D-6-P10)
	B	Bracket (6166)

Option weight

* Add to the weight of the standard accessories.

Unit: kg

Code	Bowl material				Pressure gauge	Bracket
	Drain discharge	D	Z	M		
B7019	0	0	0.08	0.03	0.086	0.03

Internal structure and parts list

● B7019

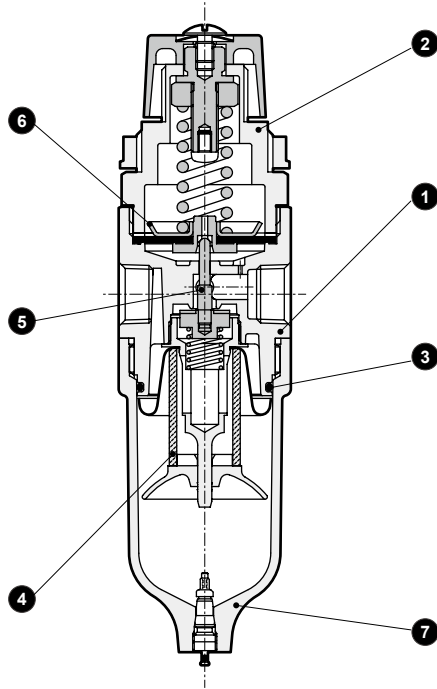

No.	Part name	Material
1	Body	Aluminum alloy die-casting
2	Cover	Polyacetal resin
3	O-ring	Special nitrile rubber
4	Element	Polypropylene
5	Valve assembly	Copper alloy/hydrogenated nitrile rubber
6	Diaphragm assembly	Nitrile rubber/copper alloy/steel
7	Bowl	Polycarbonate resin/copper alloy

Repair parts list

No.	Part name	B7019	
4	Element	A1019-ELEMENT	
5	Valve assembly	B7019-VALVE-ASSY	
6	Diaphragm assembly	Relief	B7019-DIAPHRAGM-ASSY
		Non-relief	B7019-DIAPHRAGM-ASSY-N

Dimensions



● B7019

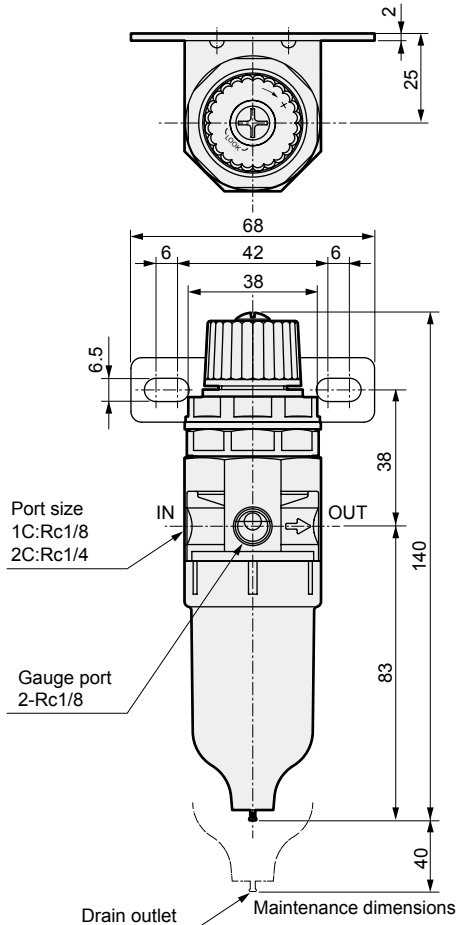

● Wall bracket: 6166
 · Material: Steel
 Zinc plated
 Bracket thickness 2 mm

