



Lubricator/econo-mist

A3019 Series

Supplying fine oil mist (oil fog).

● Port size: Rc1/8 to Rc1/4

JIS symbol



Specifications

Item	A3019-1C/2C	
Working fluid	Compressed air	
Max. working pressure	MPa	1.0 (≈150 psi, 10 bar)
Proof pressure	MPa	1.5 (≈220 psi, 15 bar)
Ambient / fluid temperatures	°C	5 (41°F) to 65 (149°F)
Oil used	Turbine oil Class 1, ISO VG32 (spindle oil cannot be used)	
Oil storage capacity	cm ³	25
Port size	Rc	1/8 / 1/4
Weight	kg	0.2
Bowl guard	Made to order	
Min. drip flow rate	ℓ/min (ANR)	20

*1: The min. drip flow rate is the value at which five drops of oil drip per minute when the primary pressure is 0.5 MPa.

Option weight

* Add to the weight of the standard accessories.

Unit: kg

Code	Drain disch	Bowl material		Bracket
	C	Z	M	B
A3019	0	0	0.08	0.035

Oil drip rate

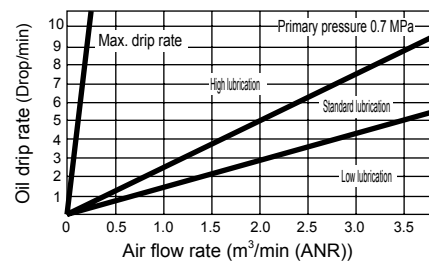

Flow characteristics

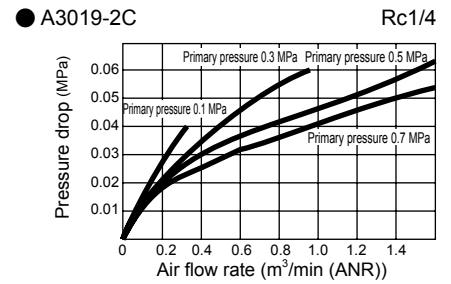
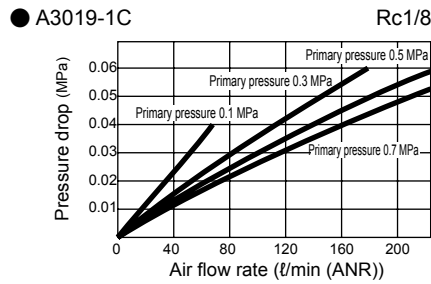

How to order

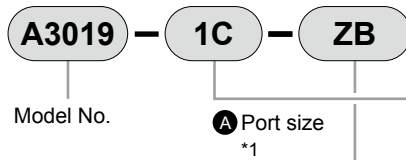

[Example of model No.]

A3019-1C-ZB

Model: Lubricator/
Econo-mist,
Miniature

A Port size: Rc 1/8

B Option: Nylon bowl,
wall bracket included

⚠ Precautions for model No. selection

*1 : If port size NPT thread is required, do not indicate nominal size C. (Example) A3019-1

*2 : Refer to page 425 for the included "B" bracket.

*3 : Consult with CKD when using the air motor with a uniform flow rate (minimal differential pressure).

*4 : The observation dome material is polyamide resin (nylon) even when a metal bowl is selected.

Code	Description	
A Port size		
1C	Rc1/8	
2C	Rc1/4	
B Option		
Drain discharge	Blank	Blank bowl
	C	Manual cock, tire valve (M: Cock)
Bowl material	Blank	Polycarbonate
	Z	Nylon bowl
	M	Metal bowl
Incl prod	Blank	Not included
	B	Wall bracket (6506)

Internal structure and parts list

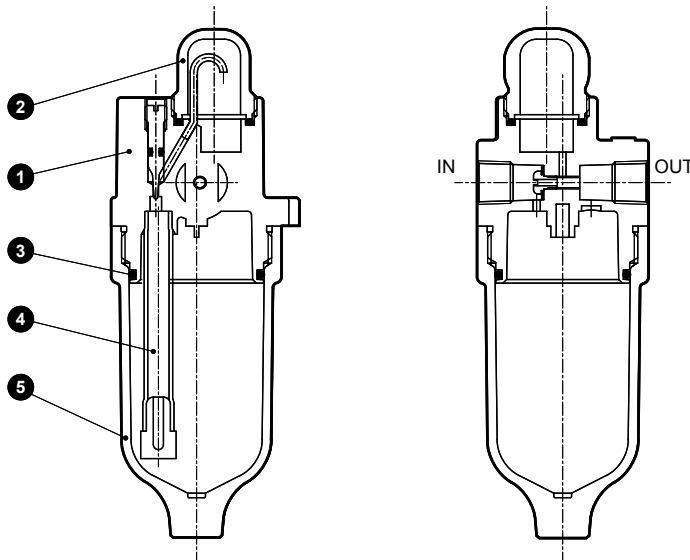

No.	Part name	Material
1	Body	Zinc alloy die-casting
2	Observation dome	Polycarbonate resin
3	O-ring	Special nitrile rubber
4	Siphon tube assembly	Polyamide resin, polypropylene
5	Bowl	Polycarbonate resin

Dimensions



● A3019

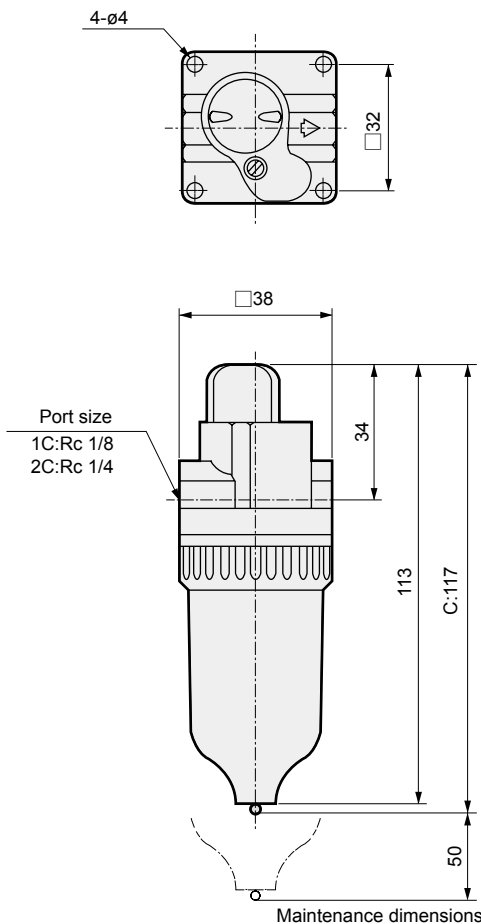

● Wall bracket: 6506
 ·Material: Steel
 Zinc plated
 Bracket thickness 2 mm

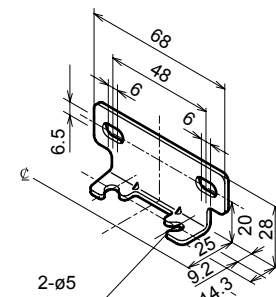

* Tapping screw attached

- F.R.L.
- F.R.
- F (Filtr)
- R (Reg)
- L (Lub)
- Drain Separ
- Mech Press SW
- Res press exh valve
- SlowStart
- Anti-bac/Bac-remove Filtr
- Film Resist FR
- Oil-ProhR
- Med Press FR
- No Cu/ PTFE FRL
- Outdrs FRL
- Adapter Joiner Press Gauge
- CompFRL
- LgFRL
- PrecsR
- VacF/R
- Clean FR
- ElecPneuR
- AirBoost
- Speed Ctrl
- Silncr
- CheckV/ other
- Fit/Tube
- Nozzle
- Air Unit
- PrecsCompn
- Electro Press SW
- ContactSW
- AirSens
- PresSW Cool
- Air Flo Sens/Ctrl
- WaterRISens
- TotAirSys (Total Air)
- TotAirSys (Gamma)
- Gas generator
- RefrDry
- DesicDry
- HiPolymDry
- MainFiltr Dischrg etc
- Ending