

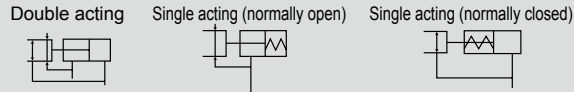

Powerful chuck with rubber cover

CKLG2 Series

- Operational stroke length: 5, 6, 8, 10, 12, 16, 20, 23 mm



Specifications

1 MPa ≈ 145.0 psi, 1 MPa = 10 bar

Item	CKLG2								
	20CS	25CS	32CS	40CS	50CS	63CS	80CS	100CS	
Size	20CS	25CS	32CS	40CS	50CS	63CS	80CS	100CS	
Bore size mm	∅20	∅25	∅32	∅40	∅50	∅63	∅80	∅100	
Working fluid	Compressed air								
Max. working pressure MPa	0.7 (≈101 psi, 7 bar)								
Min. working pressure MPa	0.3 (≈44 psi, 3 bar)								
Ambient temperature °C	5 (41°F) to 60 (140°F)								
Port size	M5					Rc1/8			
Operating stroke length mm	5	6	8	10	12	16	20	23	
Rod diameter mm	∅6	∅8	∅10	∅12	∅14	∅16		∅20	
Volumetric capacity (reciprocating) cm ³	1.8	3.3	7.7	15.6	28.3	60.3	118.2	215.5	
Repeatability mm	±0.01								
Weight kg	Standard	0.14	0.21	0.27	0.40	0.60	1.13	2.02	3.38
	O: Single acting normally open	0.17	0.25	0.33	0.52	0.71	1.30	2.59	4.00
	C: Single acting normally closed	0.17	0.25	0.33	0.52	0.71	1.39	2.71	4.10
Lubrication	Not required (use turbine oil class 1 ISO VG32 if necessary for lubrication)								

Switch specifications

Item	Proximity 2-wire	Proximity 3-wire
	T2H/V	T3H/V
Applications	Dedicated for programmable controller	For programmable controller, relay
Output method	-	NPN output
Power supply voltage	-	10 to 28 VDC
Load voltage/current	10 to 30 VDC, 5 to 20 mA (*1)	30 VDC or less, 100 mA or less
Display lamp	LED (Lit when ON)	
Leakage current	1 mA or less	10 µA or less
Weight	1 m: 18 g 3 m: 49 g 5 m: 80 g	

*1 : The above max. load current is 20 mA at 25°C.

The current is lower than 20 mA if the operating ambient temperature around the switch is higher than 25°C. (5 to 10 mA at 60°C)

*2 : Refer to Ending Page 1 for detailed switch specifications and dimensions.

- LCM
- LCR
- LCC
- LCW
- LX
- STM
- STG
- STS/STL
- STR2
- UCA2
- ULK*
- JSK/M2
- JSG
- JSC3/JSC4
- USSD
- UFCD
- USC
- UB
- JSB3
- LMB
- LML
- HCM
- HCA
- LBC
- CAC4
- UCAC2
- CAC-N
- UCAC-N
- RCS2
- RCC2
- PCC
- SHC
- MCP
- GLC
- MFC
- BBS
- RRC
- GRC
- RV3*
- NHS
- HRL
- LN
- Hand
- Chuk
- MechHnd/Chuk
- ShkAbs
- FJ
- FK
- SpdContr
- Ending
- CKL2
- CKLG2
- CKL2-HC
- CKH2
- CKLB2
- CKG
- CK
- CKA
- CKS
- CKS-F
- CKF
- CKJ
- CHC

How to order

Without switch (built-in magnet for switch)

CKLG2 - **20CS** - **O**

With switch (built-in magnet for switch)

CKLG2 - **20CS** - **O** - **T2H** - **R**

A Size

B Option*1, *2

C Switch model No.

D Switch quantity

Code	Description					
A Size						
20CS						
25CS						
32CS						
40CS						
50CS						
63CS						
80CS						
100CS						
B Option						
Blank	Standard (double acting)					
O	Single acting (normally open)					
C	Single acting (normally closed)					
Y1	With attachment (S50C)					
Y2	With attachment (MC nylon)					
C Switch model No.						
Lead wire	Lead wire	Contact	Voltage		Display	Lead wire
Straight	Radial	Proximity	AC	DC		
T2H*	T2V*				●	1-color
T3H*	T3V*			●	display	3-wire
* Lead wire length						
Blank	1 m (standard)					
3	3 m (option)					
5	5 m (option)					
D Switch quantity						
R	1 on open side					
H	1 on closed side					
D	2					

⚠ Precautions for model No. selection

*1: Attachment is commonly used for internal and external diameter chuck.

*2: Refer to pages 1868 and 1869 for the dimensions and compatible models of the attachment.

When ordered as an option, three are included at shipment.

[Example of model No.]

CKLG2-20CS-O-T2H-R

Model: Powerful chuck

- A** Size : 20CS
- B** Option : Single acting, normally open
- C** Switch model No. : Proximity T2H switch, lead wire 1 m
- D** Switch quantity : One on open side

How to order switch

SW - **T2H**

Switch model No.
(Item **C** above)

Note) When the type with two switches is selected, if the model has a short operational stroke length, both switches may turn ON depending on the workpiece size.

LCM
LCR
LCG
LCW
LCX
STM
STG
STS/STL
STR2
UCA2
ULK*
JSK/M2
JSG
JSC3/JSC4
USSD
UFCD
USC
UB
JSB3
LMB
LML
HCM
HCA
LBC
CAC4
UCAC2
CAC-N
UCAC-N
RCS2
RCC2
PCC
SHC
MCP
GLC
MFC
BBS
RRC
GRC
RV3*
NHS
HRL
LN
Hand
Chuck
MechHnd/Chuck
ShkAbs
FJ
FK
SpdContr
Ending

CKL2
CKLG2
CKL2-HC
CKH2
CKLB2
CKG
CK
CKA
CKS
CKS-F
CKF
CKJ
CHC

CKLG2 Series

Internal structure and parts list

● CKLG2-20CS to 100CS

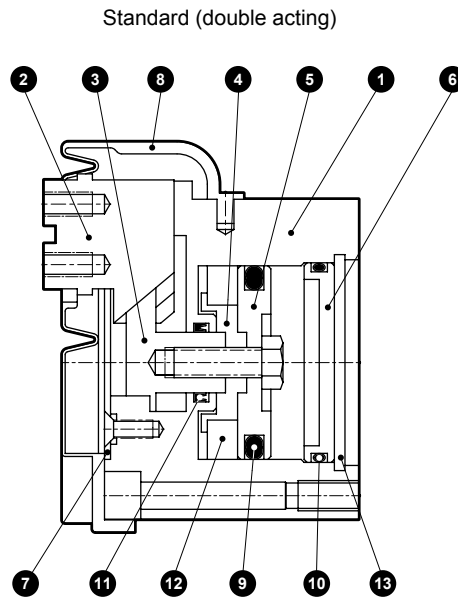

O (normally open)

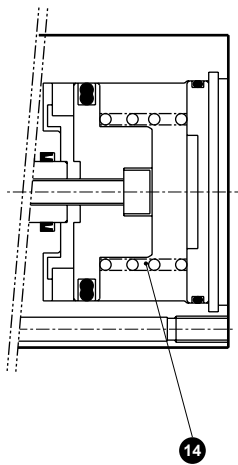

C (normally closed)

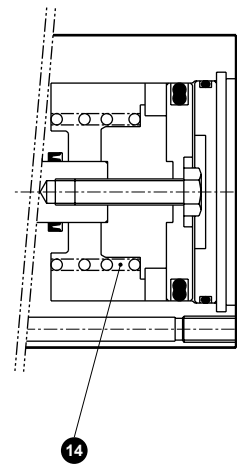

Cannot be disassembled

Parts list

No.	Part name	Material	Remarks	No.	Part name	Material	Remarks
1	Body	Aluminum alloy		8	Rubber cover	Nitrile rubber	
2	Finger	Steel		9	Piston packing	Nitrile rubber	
3	Piston A	Stainless steel (20CS to 32CS), Steel (40CS to 100CS)		10	Cylinder gasket	Nitrile rubber	
4	Piston B	Aluminum alloy		11	Rod packing	Nitrile rubber	
5	Piston C	Aluminum alloy		12	Magnet		
6	Cylinder guard	Aluminum alloy		13	C-snap ring	Stainless steel (20CS to 63CS) Steel (80CS, 100CS)	
7	Center guard	Stainless steel		14	Spring	Stainless steel	

LCM
LCR
LCG
LCW
LCX
STM
STG
STS/STL
STR2
UCA2
ULK*
JSK/M2
JSG
JSC3/JSC4
USSD
UFCD
USC
UB
JSB3
LMB
LML
HCM
HCA
LBC
CAC4
UCAC2
CAC-N
UCAC-N
RCS2
RCC2
PCC
SHC
MCP
GLC
MFC
BBS
RRC
GRC
RV3*
NHS
HRL
LN
Hand
Chuk
MecHnd/Chuk
ShkAbs
FJ
FK
SpdContr
Ending
CKL2
CKLG2
CKL2-HC
CKH2
CKLB2
CKG
CK
CKA
CKS
CKS-F
CKF
CKJ
CHC

Gripping power performance data

- Gripping power represents the thrust (per one finger) in the arrow direction shown in the figure.
- The gripping power in the opening/closing directions with finger length ℓ of the hand with a supply pressure of 0.3, 0.5 and 0.7 MPa is shown.
 - Open direction () ----- (shown with broken line)
 - Closed direction () ————— (shown with continuous line)

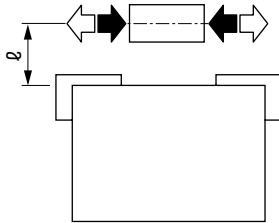

(Note) O type gripping power decreases approximately 20 to 30% in the closed direction compared to double acting.
 C type gripping power decreases approximately 10 to 20% in the open direction compared to double acting.
 For selection, see page 1872 for design and selection precautions.

● CKLG2-20CS

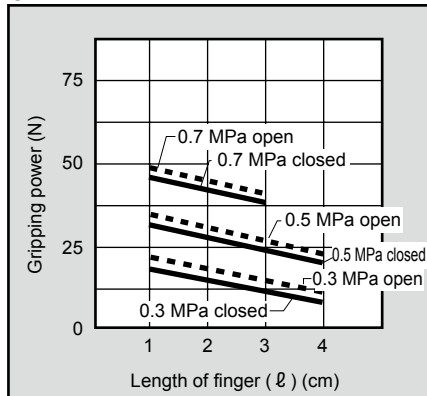

● CKLG2-25CS

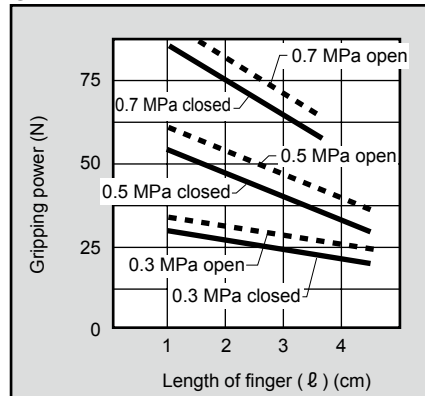

● CKLG2-32CS

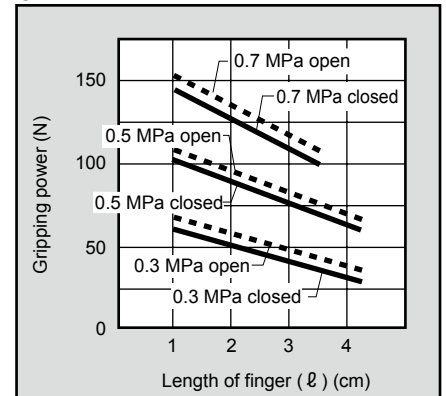

● CKLG2-40CS

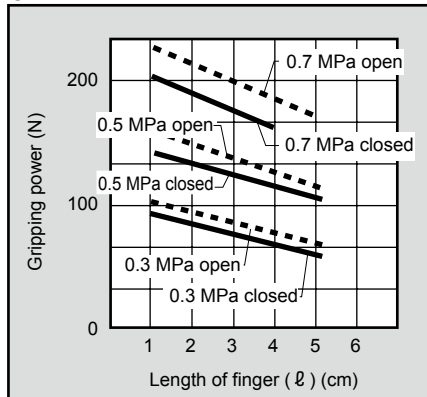

● CKLG2-50CS

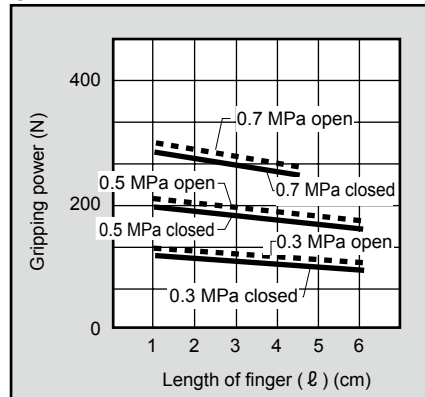

● CKLG2-63CS

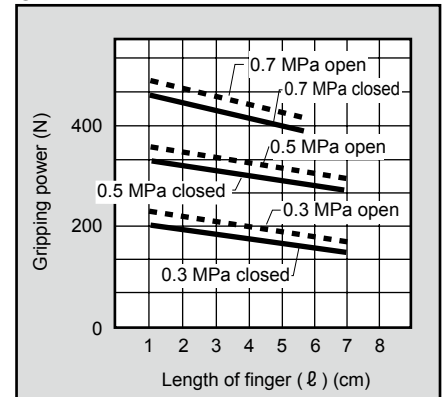

● CKLG2-80CS

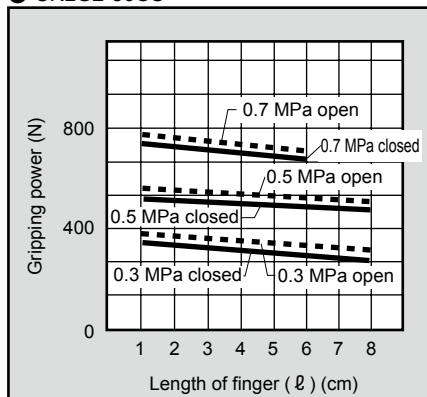

● CKLG2-100CS

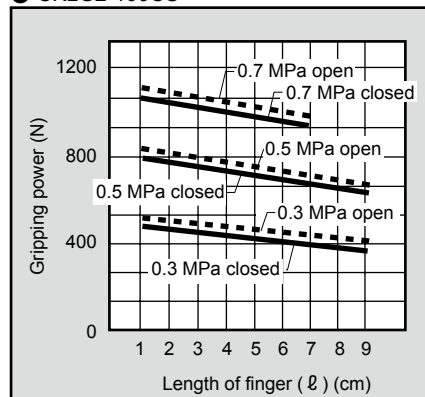

LCM
LCR
LCG
LCW
LCX
STM
STG
STS/STL
STR2
UCA2
ULK*
JSK/M2
JSG
JSC3/JSC4
USSD
UFCD
USC
UB
JSB3
LMB
LML
HCM
HCA
LBC
CAC4
UCAC2
CAC-N
UCAC-N
RCS2
RCC2
PCC
SHC
MCP
GLC
MFC
BBS
RRC
GRC
RV3*
NHS
HRL
LN
Hand
Chuk
MechAndChuk
ShkAbs
FJ
FK
SpdContr
Ending
CKL2
CKLG2
CKL2-HC
CKH2
CKLB2
CKG
CK
CKA
CKS
CKS-F
CKF
CKJ
CHC

CKLG2 Series

Dimensions

● CKLG2-20CS

· Dimensions in () are for O [normally open] and C [normally closed] specifications.

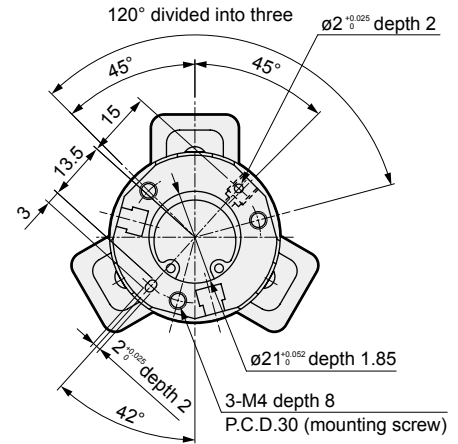
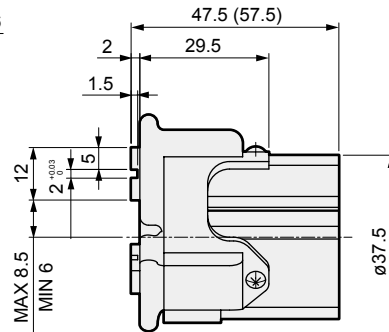
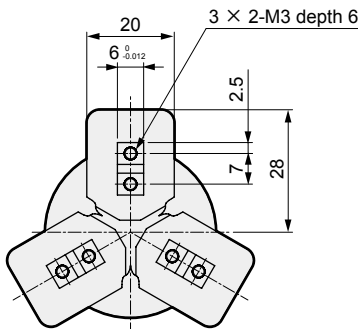
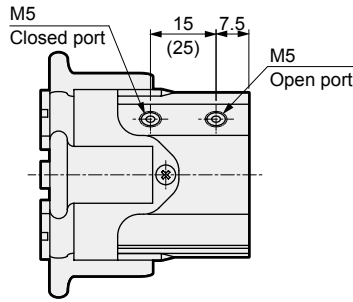

● CKLG2-25CS

· Dimensions in () are for O [normally open] and C [normally closed] specifications.

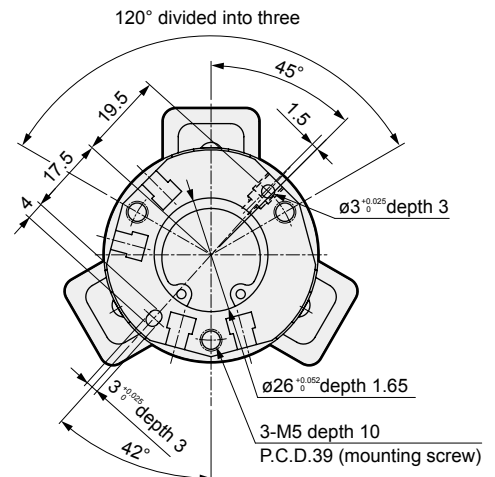
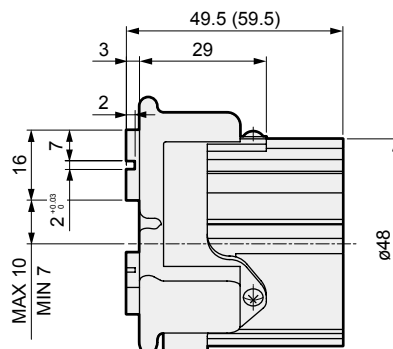
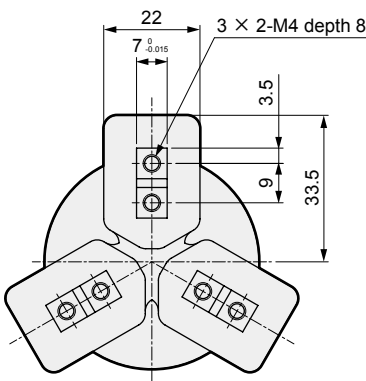
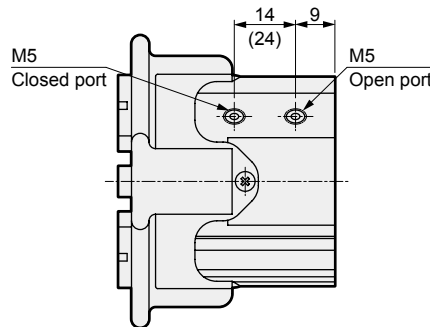

LCM
LCR
LCG
LCW
LCX
STM
STG
STS/STL
STR2
UCA2
ULK*
JSK/M2
JSG
JSC3/JSC4
USSD
UFCD
USC
UB
JSB3
LMB
LML
HCM
HCA
LBC
CAC4
UCAC2
CAC-N
UCAC-N
RCS2
RCC2
PCC
SHC
MCP
GLC
MFC
BBS
RRC
GRC
RV3*
NHS
HRL
LN
Hand
Chuk
MecHnd/Chuk
ShkAbs
FJ
FK
SpdContr
Ending

CKL2
CKLG2
CKL2-HC
CKH2
CKLB2
CKG
CK
CKA
CKS
CKS-F
CKF
CKJ
CHC

Dimensions

● CKLG2-32CS

· Dimensions in () are for O [normally open] and C [normally closed] specifications.

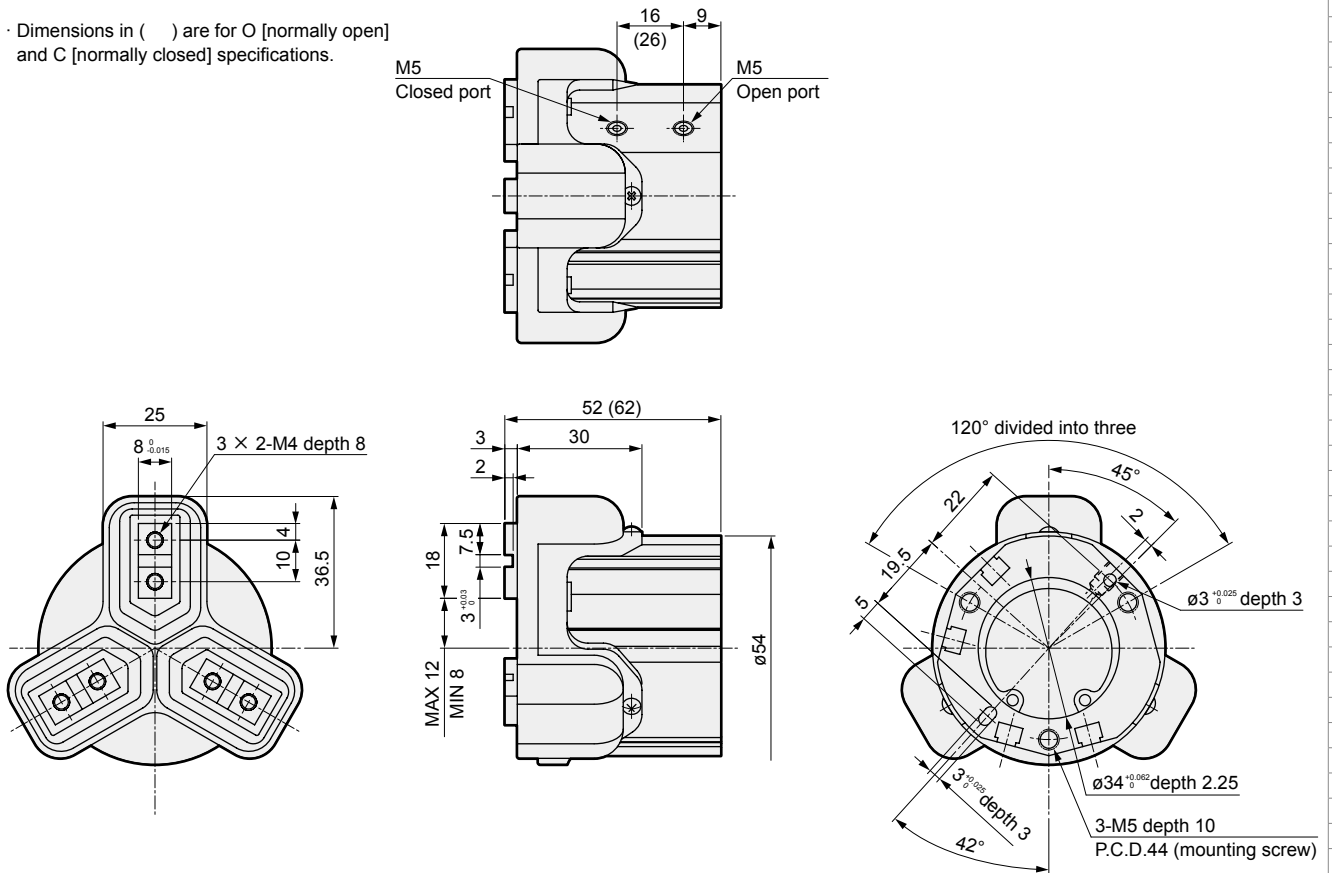

● CKLG2-40CS

· Dimensions in () are for O [normally open] and C [normally closed] specifications.

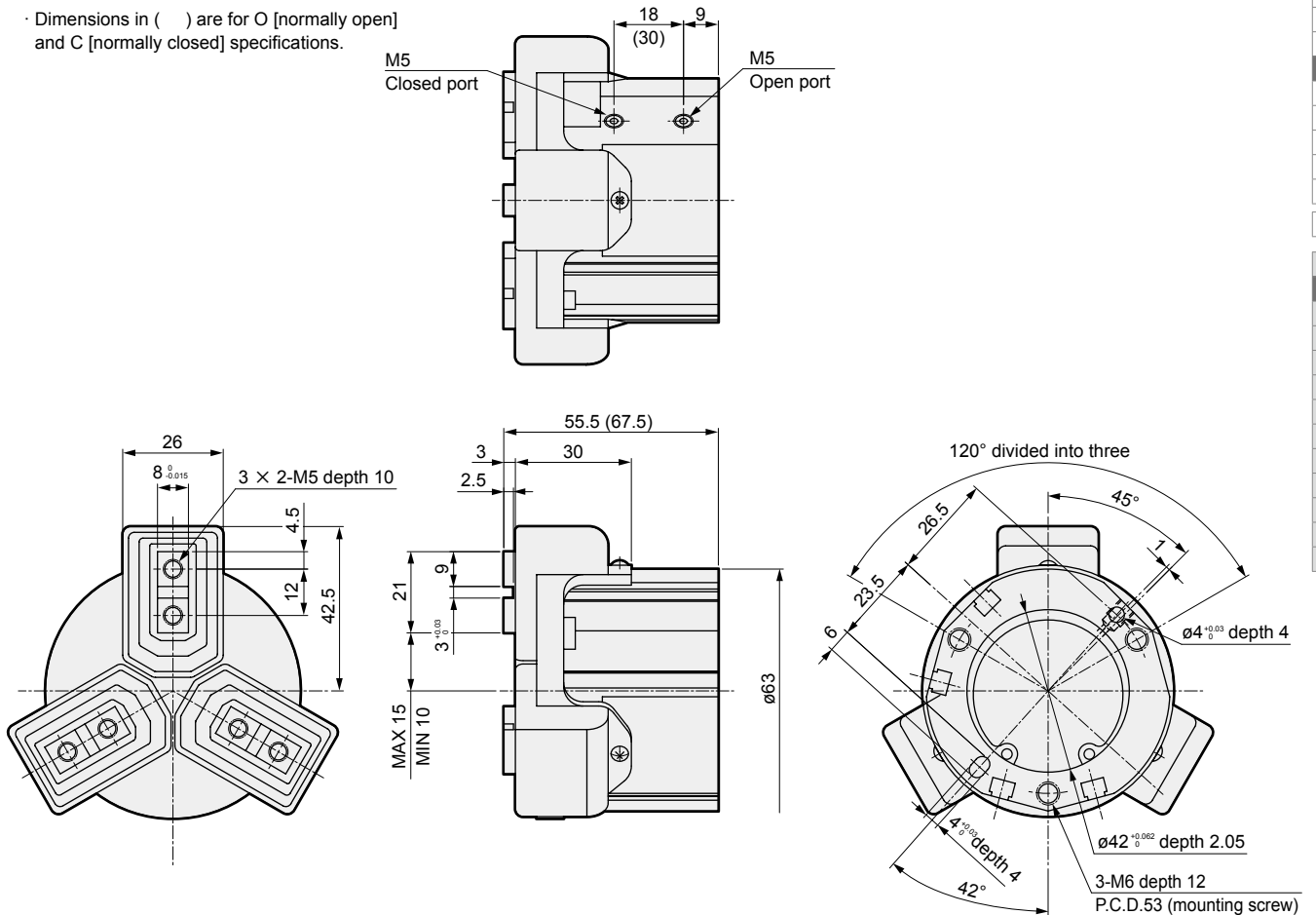

LCM
LCR
LCG
LCW
LCX
STM
STG
STS/STL
STR2
UCA2
ULK*
JSK/M2
JSG
JSC3/JSC4
USSD
UFCD
USC
UB
JSB3
LMB
LML
HCM
HCA
LBC
CAC4
UCAC2
CAC-N
UCAC-N
RCS2
RCC2
PCC
SHC
MCP
GLC
MFC
BBS
RRC
GRC
RV3*
NHS
HRL
LN
Hand
Chuk
MechHnd/Chuk
ShkAbs
FJ
FK
SpdContr
Ending
CKL2
CKLG2
CKL2-HC
CKH2
CKLB2
CKG
CK
CKA
CKS
CKS-F
CKF
CKJ
CHC

CKLG2 Series

Dimensions

● CKLG2-50CS

· Dimensions in () are for O [normally open] and C [normally closed] specifications.

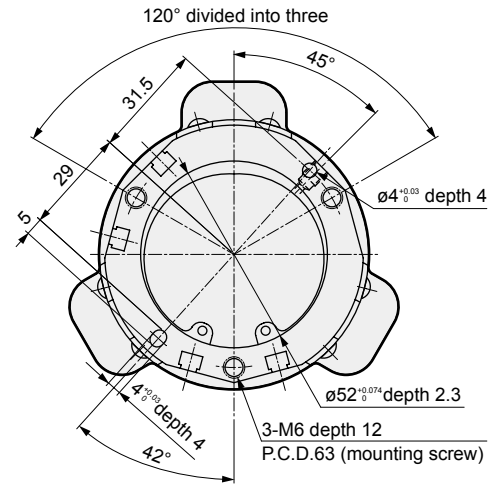
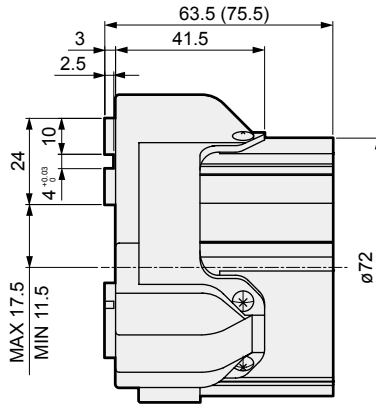
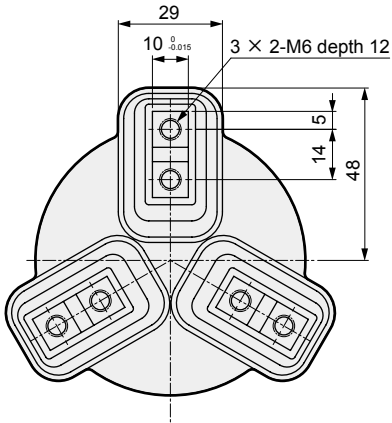
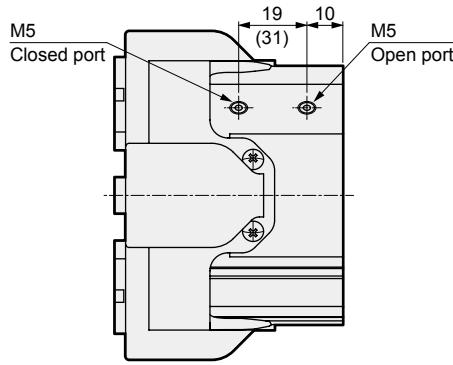

● CKLG2-63CS

· Dimensions in () are for O [normally open] and C [normally closed] specifications.

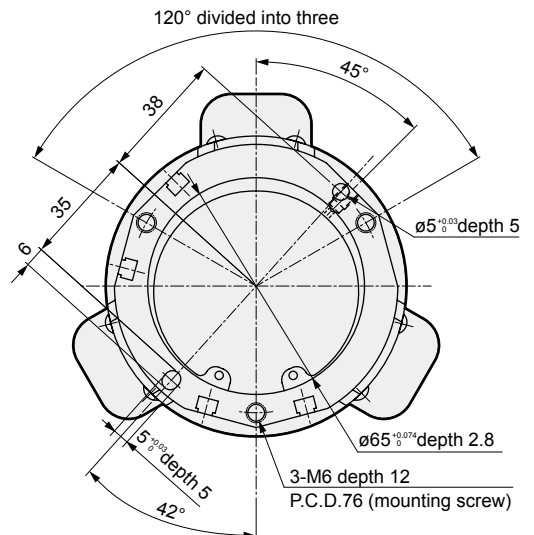
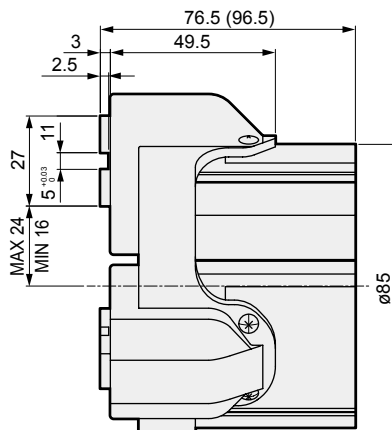
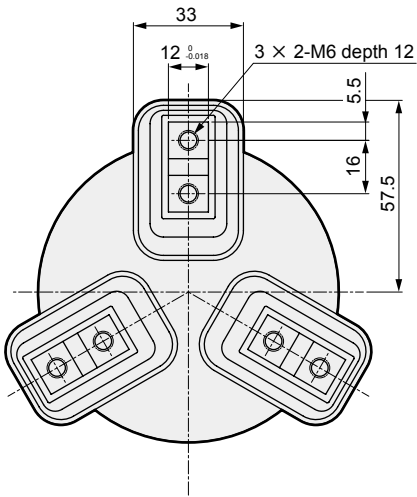
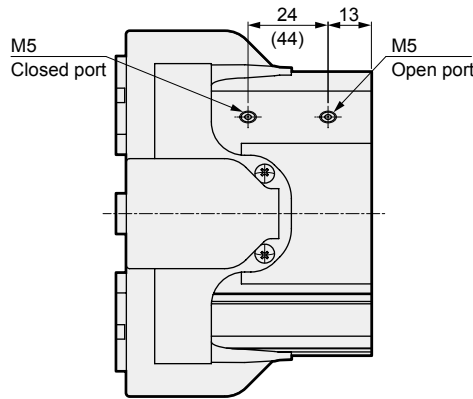

LCM
LCR
LCG
LCW
LX
STM
STG
STS/STL
STR2
UCA2
ULK*
JSK/M2
JSG
JSC3/JSC4
USSD
UFCD
USC
UB
JSB3
LMB
LML
HCM
HCA
LBC
CAC4
UCAC2
CAC-N
UCAC-N
RCS2
RCC2
PCC
SHC
MCP
GLC
MFC
BBS
RRC
GRC
RV3*
NHS
HRL
LN
Hand
Chuk
MecHnd/Chuk
ShkAbs
FJ
FK
SpdContr
Ending

CKL2
CKLG2
CKL2-HC
CKH2
CKLB2
CKG
CK
CKA
CKS
CKS-F
CKF
CKJ
CHC

Dimensions

● CKLG2-80CS

· Dimensions in () are for O [normally open] and C [normally closed] specifications.

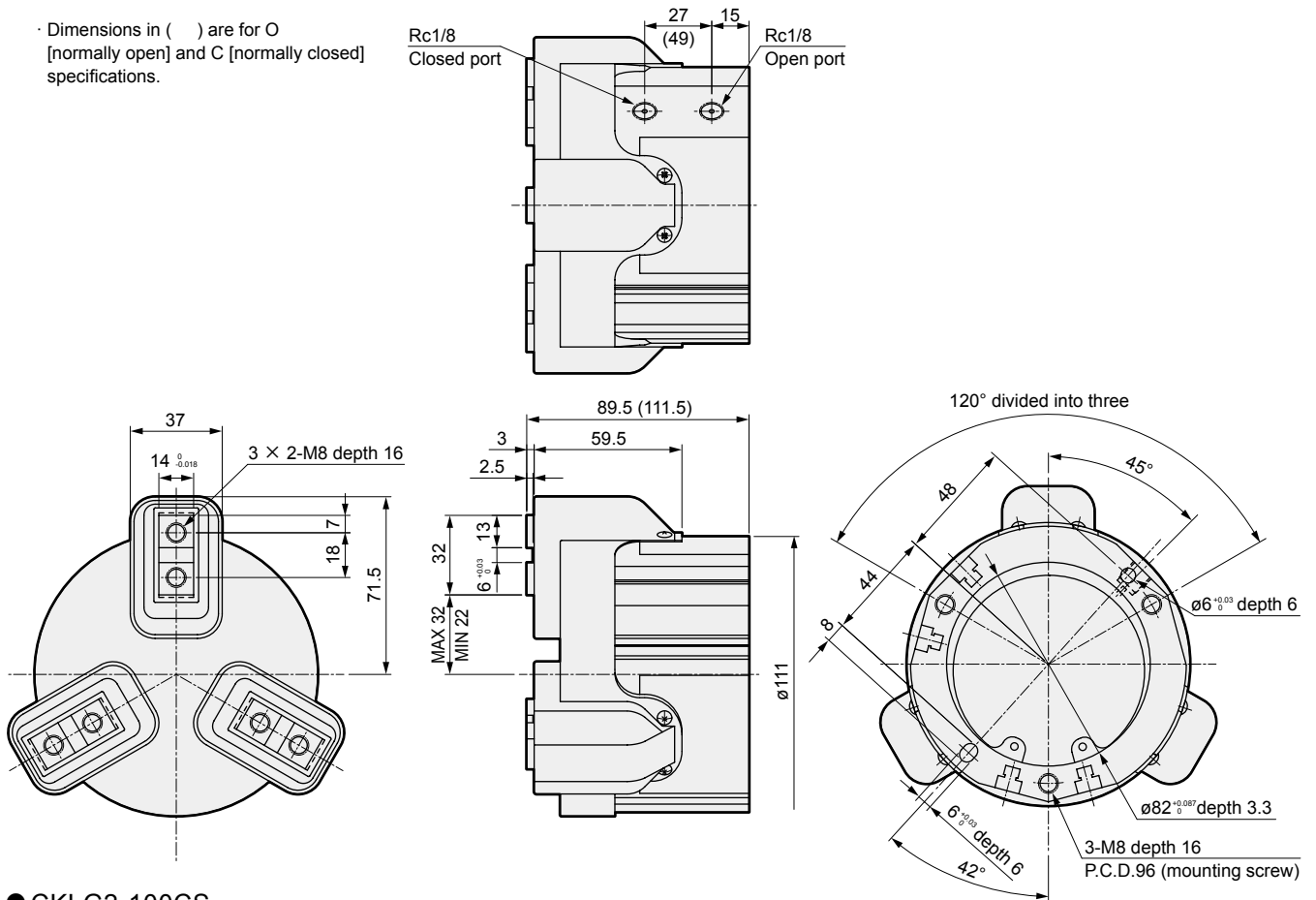

● CKLG2-100CS

· Dimensions in () are for O [normally open] and C [normally closed] specifications.

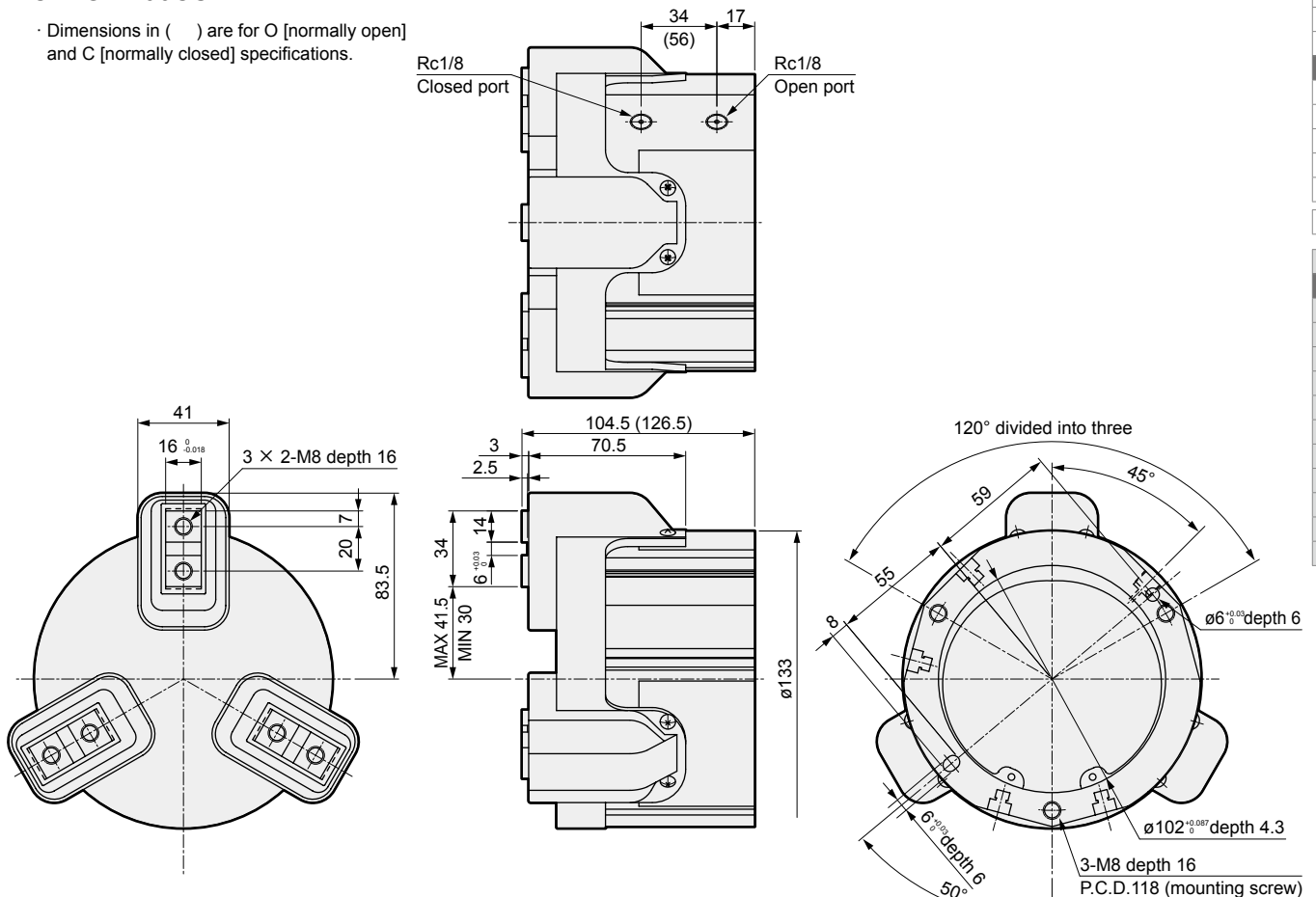

LCM
LCR
LCG
LCW
LCX
STM
STG
STS/STL
STR2
UCA2
ULK*
JSK/M2
JSG
JSC3/JSC4
USSD
UFCD
USC
UB
JSB3
LMB
LML
HCM
HCA
LBC
CAC4
UCAC2
CAC-N
UCAC-N
RCS2
RCC2
PCC
SHC
MCP
GLC
MFC
BBS
RRC
GRC
RV3*
NHS
HRL
LN
Hand
Chuk
MechHnd/Chuk
ShkAbs
FJ
FK
SpdContr
Ending
CKL2
CKLG2
CKL2-HC
CKH2
CKLB2
CKG
CK
CKA
CKS
CKS-F
CKF
CKJ
CHC