

LCM  
LCR  
LCG  
LCW  
LCX  
STM  
STG  
STS/STL  
STR2  
UCA2  
ULK\*  
JSK/M2  
JSG  
JSC3/JSC4  
USSD  
UFCD  
USC  
UB  
JSB3  
LMB  
LML  
HCM  
HCA  
LBC  
CAC4  
UCAC2  
CAC-N  
UCAC-N  
RCS2  
RCC2  
PCC  
SHC  
MCP  
GLC  
MFC  
BBS  
RRC  
GRC  
RV3\*  
NHS  
HRL  
LN  
Hand  
Chuk  
MecHnd/Chuk  
ShkAbs  
FJ  
FK  
SpdContr  
Ending  
BHA-FC  
CKL2-FC



Mechanical chuck

# CKL2-FC Series

● Operating stroke length: 5, 6, 8, 10mm



## Specifications

● CKL2-FC

Model No.	CKL2-FC			
Size	20CS	25CS	32CS	40CS
Cylinder bore size mm	ø20	ø25	ø32	ø40
Rod diameter mm	ø6	ø8	ø10	ø12
Ambient temperature °C	5 (41°F) to 60 (140°F)			
Operating stroke length mm	5	6	8	10
Repeatability mm	±0.01			
Open side external force N	165 to 250	280 to 420	485 to 730	710 to 1050
Gripping power (*2) N	20 to 33	33 to 53	50 to 105	83 to 150
Product weight g	202	320	433	834

\*1 : Never use in the open direction, as the hand may be damaged.

\*2 : Gripping power varies with stroke position.

## How to order

CKL2 - 20CS - FC

Code	
A Size	
20CS	
25CS	
32CS	
40CS	

## Internal structure and parts list

● CKL2-FC

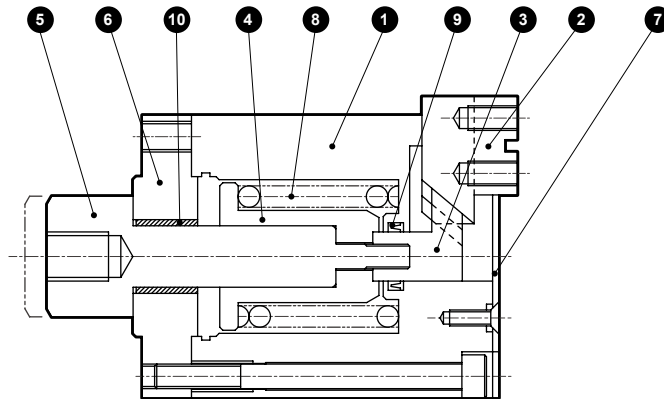

**Cannot be disassembled**

No.	Part name	Material	No.	Part name	Material
1	Body	Aluminum alloy	6	FC cylinder guard	Aluminum alloy
2	Finger	Steel	7	Center guard	Stainless steel
3	Piston A	20CS to 32CS : Stainless steel 40CS : Steel	8	Spring	Stainless steel
4	FC piston	Aluminum alloy	9	Lot sealant	Nitrile rubber
5	FC stopper rod	Stainless steel	10	Bush	Oil impregnated bearing alloy

### Dimensions



● CKL2-FC

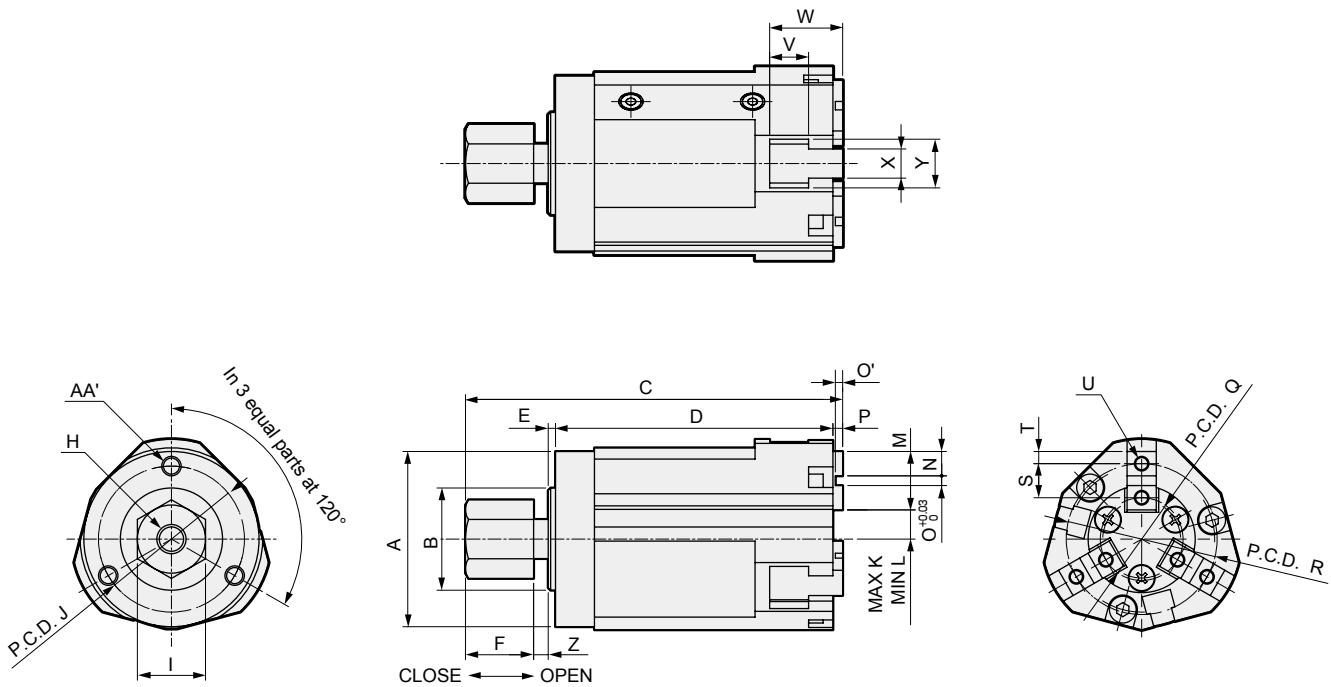

Code	A	AA'	B	C	D	E	F	H	I	J	K	L
Model No.												
CKL2-20CS-FC	ø36	3-M4 × 0.7 depth 8	ø21 <sup>0</sup> <sub>-0.052</sub>	MAX77.5/MIN74.5	57	1.5	14	M6 × 1.0 depth 9	14	30	8.5	6
CKL2-25CS-FC	ø46	3-M5 × 0.8 depth 8	ø26 <sup>0</sup> <sub>-0.052</sub>	MAX80.1/MIN76.5	58	1.5	14	M8 × 1.25 depth 10	17	39	10	7
CKL2-32CS-FC	ø52	3-M5 × 0.8 depth 10	ø34 <sup>0</sup> <sub>-0.062</sub>	MAX93/MIN88	67	2	16	M8 × 1.25 depth 12	19	44	12	8
CKL2-40CS-FC	ø62	3-M6 × 1.0 depth 12	ø42 <sup>0</sup> <sub>-0.062</sub>	MAX118/MIN111.5	90.5	2	16	M10 × 1.5 depth 15	24	53	15	10

Code	M	N	O	P	Q	R	S	T	U	V	W	X	Y	Z	O'
Model No.															
CKL2-20CS-FC	12	5	2	2	17	31	7	2.5	3 x 2-M3 x 0.5 depth 6	8	15	6 <sup>0</sup> <sub>-0.012</sub>	10	3	1.5
CKL2-25CS-FC	16	7	2	3	21	39	9	3.5	3 x 2-M4 x 0.7 depth 8	8.5	15.5	7 <sup>0</sup> <sub>-0.015</sub>	12	3.6	2
CKL2-32CS-FC	18	7.5	3	3	24	44	10	4	3 x 2-M4 x 0.7 depth 8	4	14.5	8 <sup>0</sup> <sub>-0.015</sub>	14	5	2
CKL2-40CS-FC	21	9	3	3	29	53	12	4.5	3 x 2-M5 x 0.8 depth 10	5	15	8 <sup>0</sup> <sub>-0.015</sub>	16	6.5	2.5

- LCM
- LCR
- LCG
- LCW
- LCX
- STM
- STG
- STS/STL
- STR2
- UCA2
- ULK\*
- JSK/M2
- JSG
- JSC3/JSC4
- USSD
- UFCD
- USC
- UB
- JSB3
- LMB
- LML
- HCM
- HCA
- LBC
- CAC4
- UCAC2
- CAC-N
- UCAC-N
- RCS2
- RCC2
- PCC
- SHC
- MCP
- GLC
- MFC
- BBS
- RRC
- GRC
- RV3\*
- NHS
- HRL
- LN
- Hand
- Chuk
- MechHnd/Chuk
- ShkAbs
- FJ
- FK
- SpdContr
- Ending
- BHA-FC
- CKL2-FC