

F.R.L.
F.R.
F (Filtr)
R (Reg)
L (Lub)
Drain
Separ
Mech
Press SW
Res press
exh valve
SlowStart
Anti-bac/Bac-
remove Filtr
Film
Resist FR
Oil-Prohr
Med
Press FR
No Cu/
PTFE FRL
Outdrs FRL
Adapter
Joiner
Press
Gauge
CompFRL
LgFRL
PrecsR
VacF/R
Clean FR
ElecPneUR
AirBoost
Speed Ctrl
Silncr
CheckV/
other
Fit/Tube
Nozzle
Air Unit
PrecsCompn
Electro
Press SW
ContactSW
AirSens
PresSW
Cool
Air Flo
Sens/Ctrl
WaterRtSens
TotAirSys
(Total Air)
TotAirSys
(Gamma)
Gas
generator
RefrDry
DesiccDry
HiPolymDry
MainFiltr
Dischrg
etc
Ending

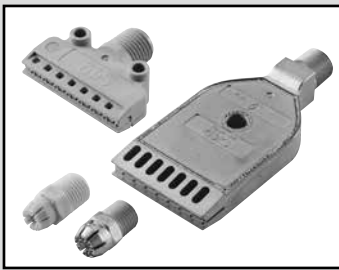

Air blow nozzle (Energy-saving)

BNE Series

● Port size: R1/4



Features

- An energy-saving air nozzle that sucks in the surrounding air and amplifies it.
- Two types available: flat type that blows uniformly along the width and round type that blows with a pinpoint aim. Also, uniformly distributed air injection enables high blowing efficiency and reduced air consumption.
- Resin type and metal type available, allowing for selection based on the use or environment.
- A work environment-friendly silent design.

Specifications

1 MPa ≈ 145.0 psi, 1 MPa = 10 bar

Item	BNE-8P10F	BNE-8S10F	BNE-8P10R	BNE-8S10R
Max. working pressure MPa	0.7 (≈101 psi, 7 bar)	1.0 (≈145 psi, 10 bar)	0.7 (≈101 psi, 7 bar)	1.0 (≈145 psi, 10 bar)
Heat resistance temperature °C	120 (248°F)	400 (752°F)	60 (140°F)	400 (752°F)
Port size	R 1/4			
Weight g	9	144	2	12
Hole diameter mm	1.0			
Number of holes	16	16	8	8
Air consumption *1 ℓ/min (ANR)	440		245	

*1: Air consumption is the reference value of atmospheric pressure conversion at standard pressure 0.3 MPa.

Air patterns

● Flat



● Round



How to order

BNE - **8** **P** **10** **F**

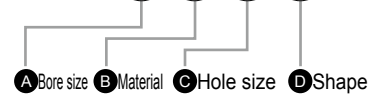

Code	Description
A Bore size	
8	R1/4
B Material	
P	Resin
S	Metal (stainless steel)
C Hole size	
10	ø1.0
D Shape	
F	Flat (42 mm)
R	Round

Air consumption characteristics *Values in the air consumption characteristics graph are reference values and are not guaranteed.

Flat

● BNE-8P10F

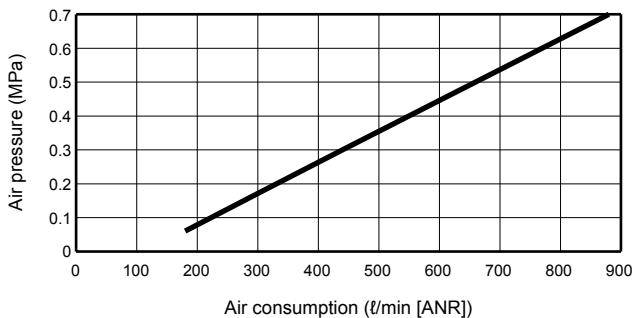

● BNE-8S10F

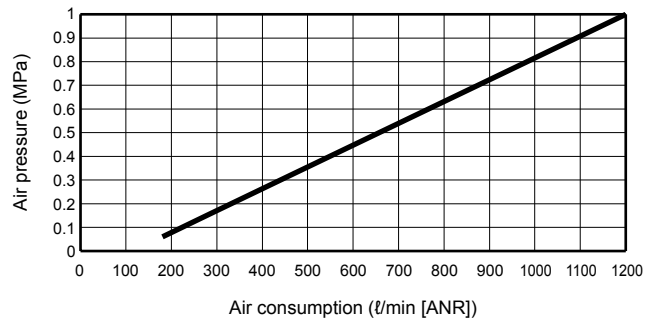

Round

● BNE-8P10R

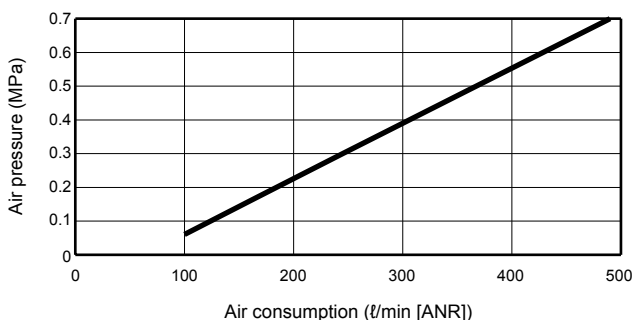

● BNE-8S10R

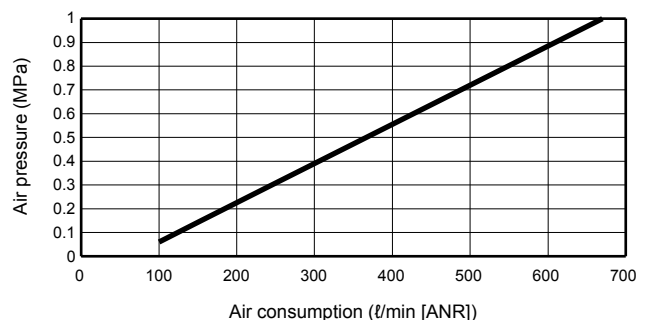

Dimensions

Flat

- BNE-8P10F

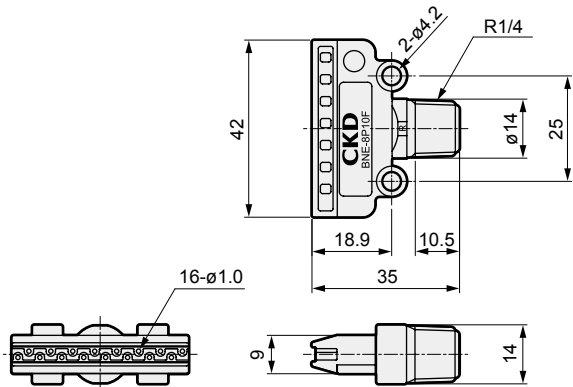

Material: PPS

- BNE-8S10F

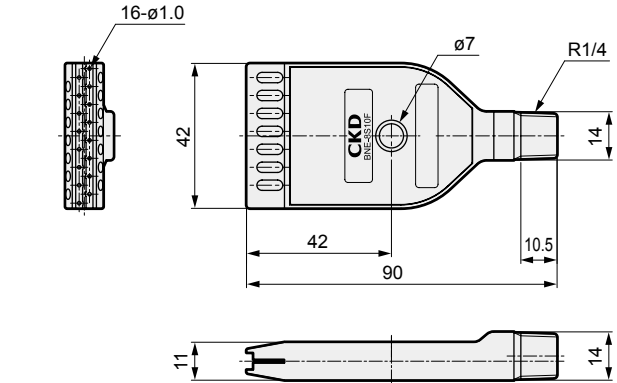

Material: Stainless steel 316L

Round

- BNE-8P10R

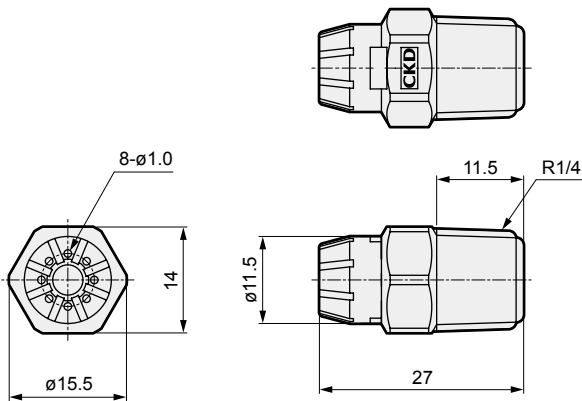

Material: PP

- BNE-8S10R

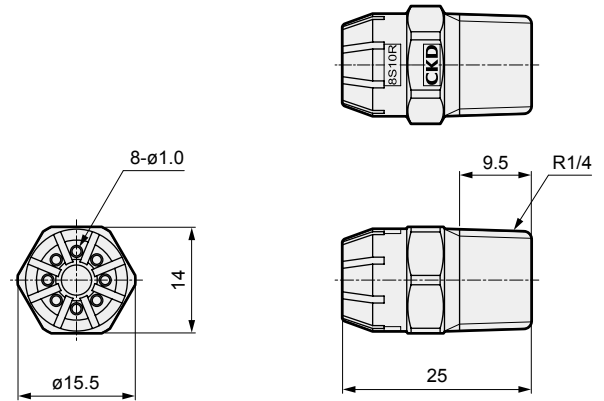

Material: Stainless steel 316L

(Reference) Amplification effect characteristics (Reference) Silent effect characteristics

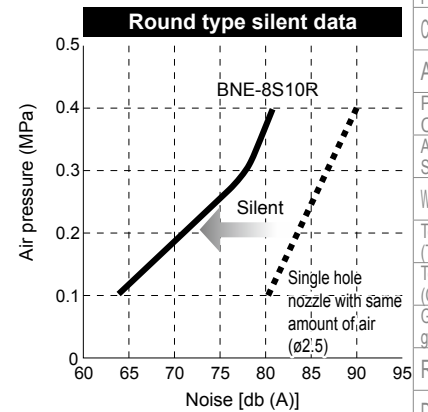
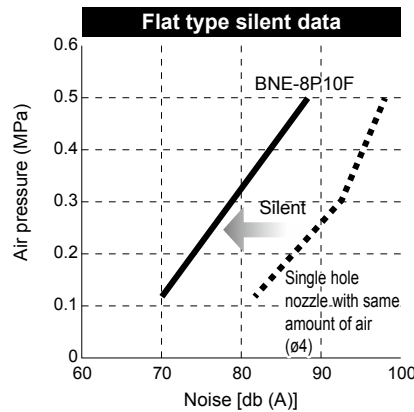
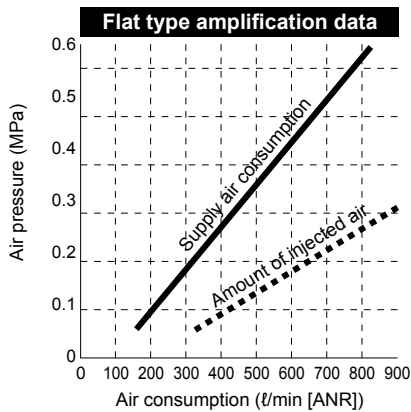

- Measurement position: 1 m in front of nozzle (1 m height)
- Background noise value: 58 dB (A)

- F.R.L.
- F.R.
- F (Filtr)
- R (Reg)
- L (Lub)
- Drain Separ
- Mech Press SW
- Res press exh valve
- SlowStart
- Anti-bac/Bac-remove Filtr
- Film Resist FR
- Oil-Prohr
- Med Press FR
- No Cu/ PTFE FRL
- Outdrs FRL
- Adapter Joiner
- Press Gauge
- CompFRL
- LgFRL
- PrecsR
- VacF/R
- Clean FR
- ElecPneuR
- AirBoost
- Speed Ctrl
- Silncr
- CheckV/ other
- Fit/Tube
- Nozzle**
- Air Unit
- PrecsCompn
- Electro Press SW
- ContactSW
- AirSens
- PresSW Cool
- Air Flo Sens/Ctrl
- WaterRISens
- TotAirSys (Total Air)
- TotAirSys (Gamma)
- Gas generator
- RefrDry
- DesicDry
- HiPolymDry
- MainFiltr
- Dischrg etc
- Ending



Air blow nozzle (General)

BN Series

● Port size: R1/8, R1/4



Features

- A single hole nozzle that injects air very directly.
- Uses highly corrosion-resistant stainless steel 303.
- Ideal for use in dense areas and in large amounts because it is compact and has good cost performance.

Air pattern



Specifications

1 MPa ≈ 145.0 psi, 1 MPa = 10 bar

Item	BN-6S10P	BN-8S10P	BN-6S15P	BN-8S15P	BN-6S20P	BN-8S20P	BN-6S25P	BN-8S25P
Max. working pressure MPa	1.0 (≈145 psi, 10 bar)							
Heat resistance temperature °C	400 (752°F)							
Port size	R 1/8	R 1/4	R 1/8	R 1/4	R 1/8	R 1/4	R 1/8	R 1/4
Weight	g 7.2	19	7.2	19	7.2	19	7.2	19
Hole diameter	mm 1.0		1.5		2.0		2.5	
Air consumption *1	l/min (ANR) 35		80		138		215	

*1: Air consumption is the reference value of atmospheric pressure conversion at standard pressure 0.3 MPa.

How to order

● Blow nozzle (General)

BN - 8 S 10 P

A Bore size **B** Material

C Hole size

D Shape

Code	Description
A Bore size	
6	R1/8
8	R1/4
B Material	
S	Metal (stainless steel)
C Hole size	
10	ø1.0
15	ø1.5
20	ø2.0
25	ø2.5
D Shape	
P	Direct (point)

Dimensions

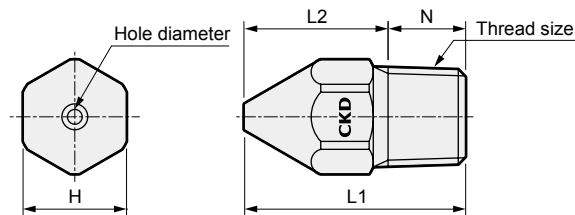

Material: Stainless steel 303

Model No.	Thread size	L1	L2	H	N	Hole diameter
BN-6S10P	R1/8	21	14	10	7	1.0
BN-6S15P	R1/8	21	14	10	7	1.5
BN-6S20P	R1/8	21	14	10	7	2.0
BN-6S25P	R1/8	21	14	10	7	2.5
BN-8S10P	R1/4	30	19.5	14	10.5	1.0
BN-8S15P	R1/4	30	19.5	14	10.5	1.5
BN-8S20P	R1/4	30	19.5	14	10.5	2.0
BN-8S25P	R1/4	30	19.5	14	10.5	2.5

Air consumption characteristics

*Values in the air consumption characteristics graph are reference values and are not guaranteed.

● BN-□S10P

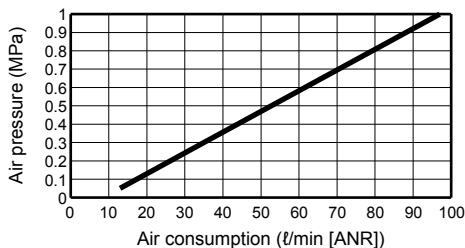

● BN-□S15P

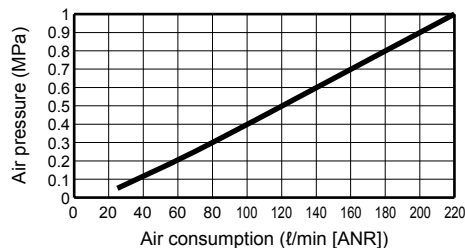

● BN-□S20P

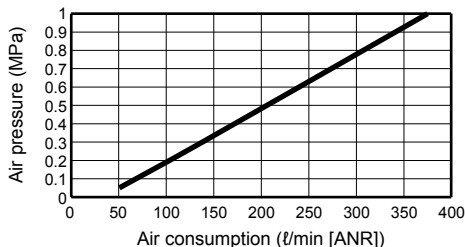

● BN-□S25P

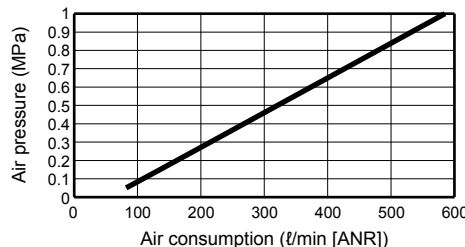



Air blow nozzle (Blower specification)

BNB Series

● Port size: R1/8, R1/4



Features

- A combination blower, compressor and air nozzle that injects blower air efficiently.
- Can be attached in narrow spaces due to a compact size.
- A highly-efficient nozzle that can inject air over a wide range with high force

Specifications

1 MPa ≈ 145.0 psi, 1 MPa = 10 bar

Item	BNB-6S15T	BNB-8S15T
Max. working pressure MPa	0.7 (≈101 psi, 7 bar)	
Heat resistance temperature °C	400 (752°F)	
Port size R	1/8	1/4
Weight g	10	16
Hole size (W x H) mm	13 x 1.5	17 x 1.5
Air Consumption rate *1 m ³ /min (ANR)	0.17	0.24
*2 l/min (ANR)	736	1,016

*1: Air consumption is the reference value of atmospheric pressure conversion at standard pressure 20 kPa.
*2: Air consumption is the reference value of atmospheric pressure conversion at standard pressure 0.3 MPa.

(Reference) Force distribution

● BNB-6S15T

Spray pressure: 20 kPa, air consumption: 0.17 Nm³/min, spray height: 100 mm

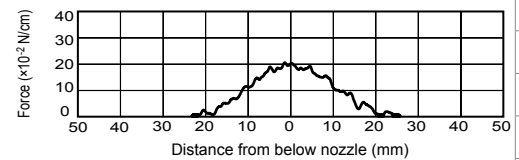

● BNB-8S15T

Spray pressure: 20 kPa, air consumption: 0.24 Nm³/min, spray height: 100 mm

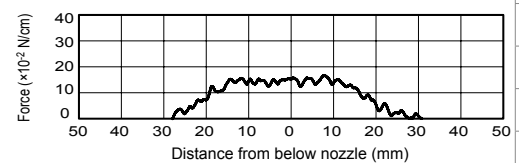

How to order

BNB - 8 S 15 T

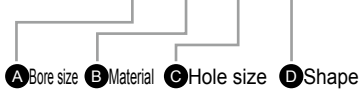

Code	Description
A Bore size	
6	R1/8
8	R1/4
B Material	
S	Metal (stainless steel)
C Hole size	
15	13x1.5 (R1/8), 17x1.5 (R1/4)
D Shape	
T	Fan-type

Dimensions

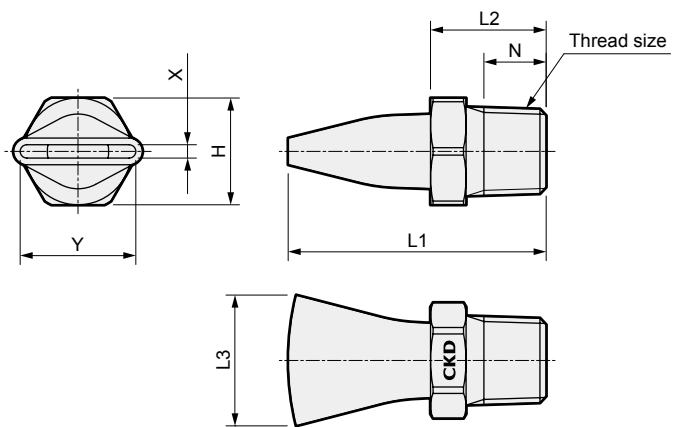

Material: Stainless steel 304

Model No.	Thread size	L1	L2	L3	X	Y	H	N
BNB-6S15T	R1/8	29	13	14.7	1.5	13	12	7
BNB-8S15T	R1/4	37	17.5	18.9	1.5	17	14	10.5

Air consumption characteristics (with blower air)

*Values in the air consumption characteristics graph are reference values and are not guaranteed.

● BNB-6S15T

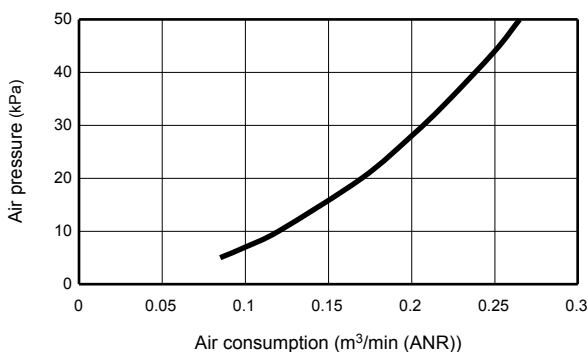

● BNB-8S15T

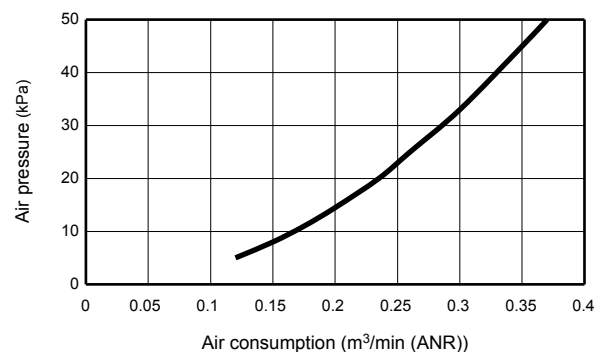

F.R.L.
F.R.
F (Filtr)
R (Reg)
L (Lub)
Drain Separ
Mech Press SW
Res press exh valve
SlowStart
Anti-bac/Bac-remove Filtr
Film Resist FR
Oil-ProhR
Med Press FR
No Cu/ PTFE FRL
Outdris FRL
Adapter Joiner Press Gauge
CompFRL
LgFRL
PrecsR
VacF/R
Clean FR
ElecPneuR
AirBoost
Speed Ctrl
Silncr
CheckV/ other
Fit/Tube
Nozzle
Air Unit
PresCompn
Electro Press SW
ContactSW
AirSens
PresSW Cool
Air Flo Sens/Ctrl
WaterRISens
TotAirSys (Total Air)
TotAirSys (Gamma)
Gas generator
RefrDry
DesicDry
HiPolymDry
MainFiltr
Dischrg etc
Ending